

how to set up a stereo microscope

Setting up your stereo microscope properly is essential to getting parfocal images during the entire zoom range. It also prevents head aches, stressful eyes and fatigue. Below you will find a setup guide that will help get the best out of your microscope

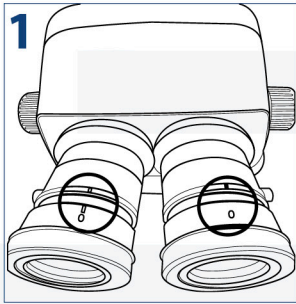

1 Turn the diopter adjustment rings of both eyepieces to position "0"

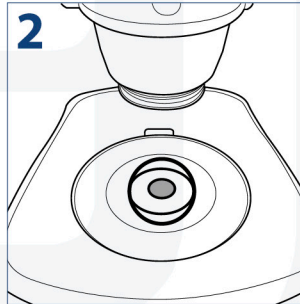

2 Put a specimen on the stage plate

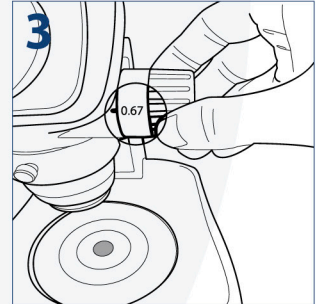

3 Turn the zoom adjustment knob to the lowest magnification

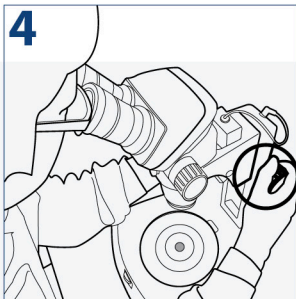

4 Rotate the focus adjustment knob to bring the specimen into focus

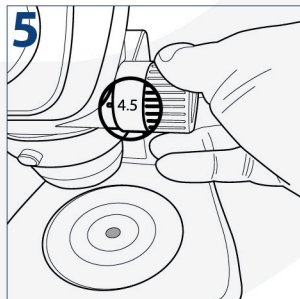

5 Turn the zoom adjustment knob to the highest magnification

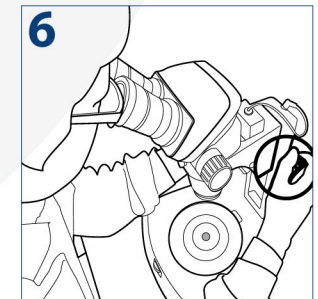

6 Rotate the focus adjustment knob to bring the specimen into focus

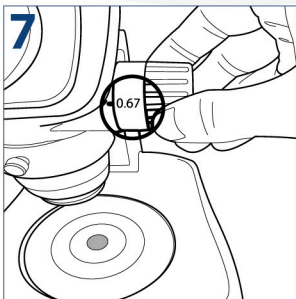

7 Turn the zoom adjustment knob to the lowest magnification

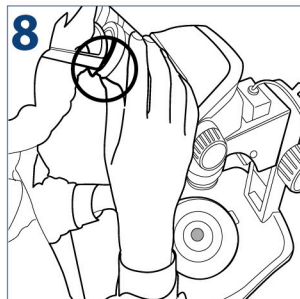

8 Rotate the diopter adjustment rings of the left and right eyepiece to bring the specimen into focus

PLEASE NOTE

Put the zoom adjustment knob at the highest magnification again and check the image focusing. The diopter adjustment is complete when the image is accurately focused during zooming

If not, please repeat steps 3 to 8